

PETTAPIECE CEMETERY

S.E. corner of 24-13-21 WPM



PETTAPIECE CEMETERY

1882 – 2024

Original November 2006

Update May 2025

Original prepared by
Wayne and Irene Pettapiece
11620-48 Ave
Edmonton, Alberta T6H 0E6
Email: pettapwi@telusplanet.net

From cemetery records supplied by
Kaye Wolstenholme
Box 403
Rivers, Manitoba R0K 1X0

Maintained by
Kathleen Shanks
Box 702
Rivers, Manitoba R0K 1X0
Email: kshnks@gmail.com

INTRODUCTION

The Pettapiece Cemetery was established in 1882 on land owned by William Shanks. It is located in the S.E. corner of 24-13-21 WPM (approx. 8 km N and 1.6 km E of Rivers, Manitoba)

The Ephriam Graham family arrived from Ontario in mid-March 1982. With them came their invalid thirteen year old daughter Laura. Her death in June of that year was the first in the community. Mr. Graham with his neighbor, William Shanks, walked over their adjacent land seeking a suitable location for the burying ground. Being wet that spring, high ground on the south-east corner of Mr. Shanks' homestead (24-13-21) was chosen. The grave was marked with a picket fence.

In the early years this cemetery served not only this district but other areas within a radius of many miles including Rivers, Rapid City, Cardale and Oak River. However, it was not until 1911 that a deed to the land was registered at the land titles at Neepawa. The first trustees were Samuel Grummet, Matthias Pettapiece and George Kelly. The early graves are duly recorded but there is no record of business prior to that time. However in the Annual report of the church it is recorded that a fence was erected and trees planted around the cemetery in 1907. Receipts for that year were \$33.00, with expenses of \$20.00 and a balance on hand of \$13.00.

The records tell of a new fence being erected and more spruce seedlings from Riding Mountain planted in 1916. Through the intervening years the grounds have been steadily improved. With financial assistance in later years from the Municipalities of Blanshard and Saskatchewan and volunteer help, the cemetery is well maintained. An annual meeting and work-bee is held each year in the summer. The trustees are elected for a three year term, one retiring each year.

When the Pettapiece Church was closed and removed it was decided by the members of the church board to erect pillars for the cemetery gates as a memorial to the founders and workers of the church. A committee representing the church, the cemetery and the Pettapiece Women's Club, arranged to have the pillars built and a suitable plaque inscribed. The cemetery contributed the new gates. Many friends contributed to the pillars. The memorial gates were dedicated Centennial year 1967. Dr. H. J. Harland officiated assisted by former ministers the Rev. W. R. Donogh and Dr. Wesley Harland as guest speakers. Several members of pioneer families took part in the service. The inscription on the plaque "Ye are the salt of the earth" is a fitting epitaph to all the pioneers buried within the gates.

There have only been three "caretakers" since 1911: Thomas Shanks (1911 - 1945), Gordon Shanks (1946 - 1982) and Kaye Wolstenholme (1983 to present). The Rural Municipality of Oakview (formerly Blanshard) administers a perpetual care fund on behalf of the cemetery. Any inquiries should be directed to:

The Rural Municipality of Oakview

Box 179, 10 Cochrane Street

Oak River, Manitoba, Canada

ROK ITO

Ph. (204) 566-2146

Fax (204) 566-2126

Email info@rmfoakview.ca

The following information is available on this site:

rmfoakview.ca /

Residents / Cemeteries / Pettapiece Cemetery / Pettapiece Cemetery Information

TABLE OF CONTENTS

INTRODUCTION	1
1. PLOT LAYOUT	3
1.1 General outline.....	3
1.2 Plot details.....	4
2. PLOT DATA FROM CEMETERY RECORDS	5
3. MONUMENTAL (TOMBSTONE) INSCRIPTIONS	21
4. NOMINAL INDEX OF NAMES	41

1. PLOT LAYOUT

1.1 General outline

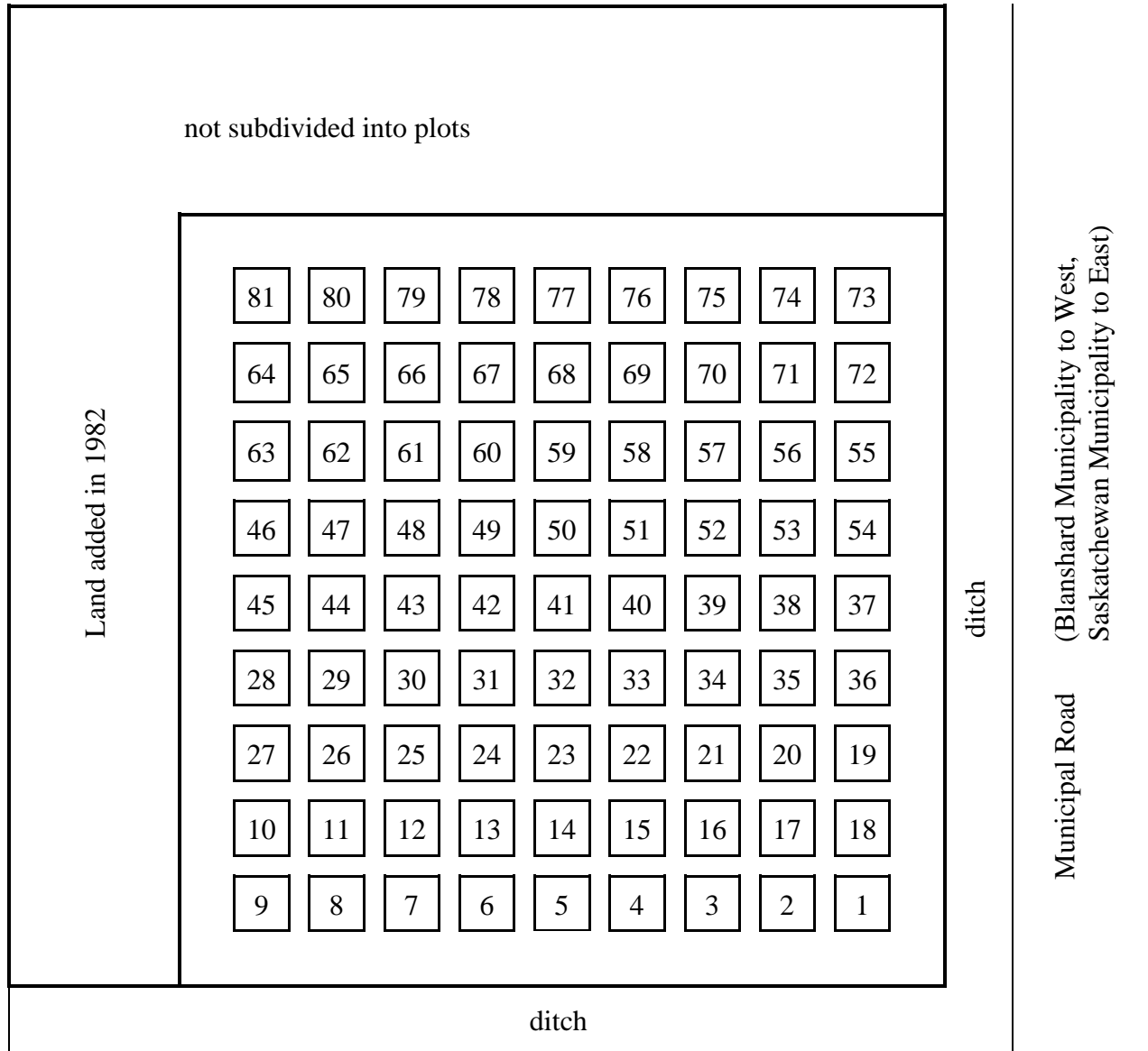
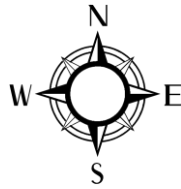

S.E. corner of 24-13-21 WPM.

Plots are 16 feet x 16 feet, pathways are 6 feet.

1.2 Plot details

Showing subdivision (subplot) numbering

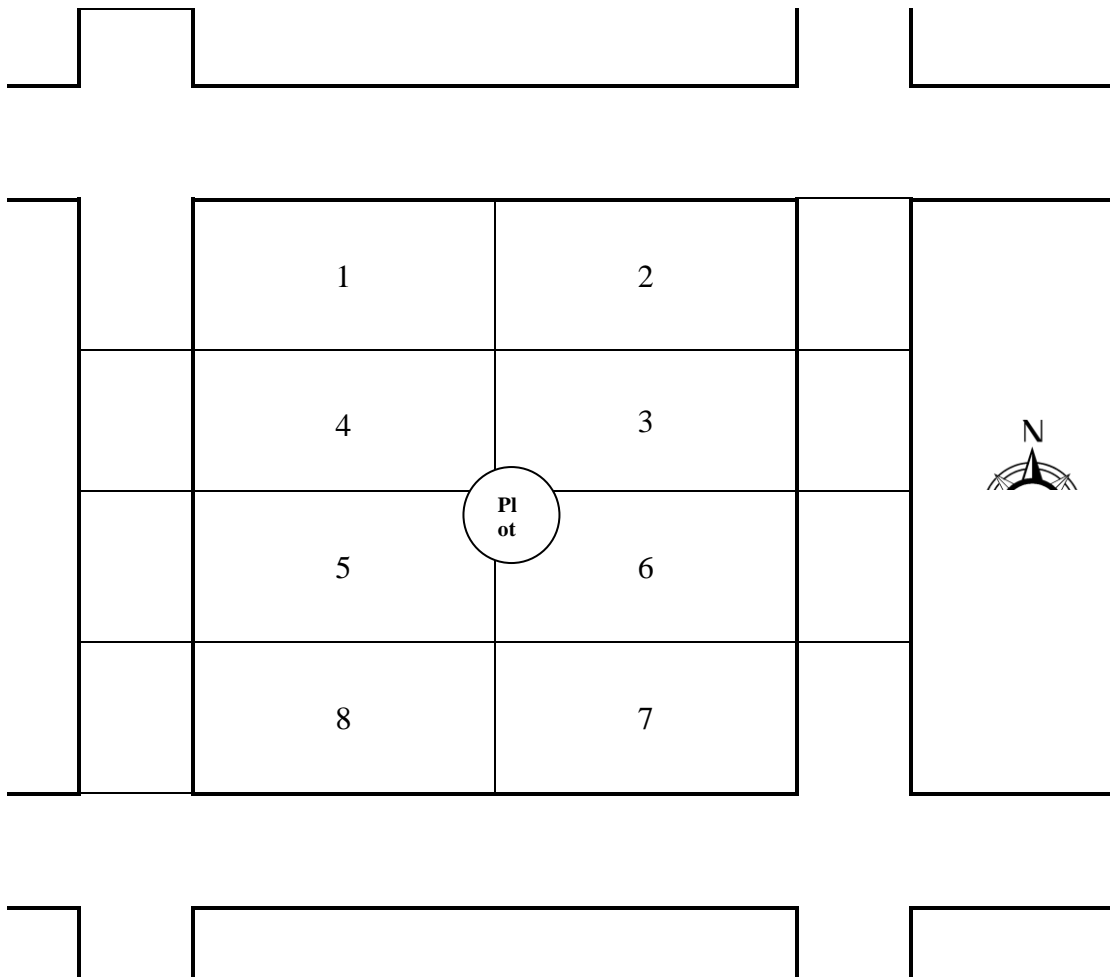

Subplots = 4 feet x 8 feet

All the graves are oriented E-W

Headstones generally face east.

They may be in the centre of the plot or at the head of any of the subplots.

Subplot designation: CW = cremation with burial on westerly half

CE = cremation with burial on easterly half

COL = columbarium – for private family burials

2. PLOT DATA FROM CEMETERY RECORDS

Please see explanatory notes at end of section

Plot #	Subplot	Person buried	Date of burial	Age
1	1			
	2	Capt. John Lawson Kite (monument)		93 yrs
	3CW	Doreen Patricia (Kite) Shanks	17 Sept 2023	95 yrs
	4	George Robert Kite	13 July 1960	72 yrs
	5	Janette Burnett Kite	02 Mar 1977	84 yrs 9 mos
	6 CW	Marianne Janette (Kite) Hurley	19 June 2015	89 yrs
	7	Victor Kite	22 Jan 1957	59 yrs 7 mos
	8			
2	1	Mrs Ethel Ellis & child		
	2	Geo Haiyuck child		
	3	Tony Ticonice		8 mos
	4			
	5			
	6			
	7			
	8			
3	1	Beatrice Dunsmore	1910	8 yrs
	2	J.W. Forman child		3 wks
	3			
	4	D. Down child		
	5	G. (Gladys Linder Edna) Snuggs	14 Jan 1910	6 yrs 10 mos
	6			
	7			
	8			
4	1			
	2			
	3			
	4			
	5			
	6			
	7	Mrs Harry Tait	17 Jan 1935	39 yrs
	8			
5-7	1			
	2			
	3			
	4	ALL VACANT		
	5			
	6			
	7			
	8			

Plot data from cemetery records cont.

Plot #	Subplot	Person buried	Date of burial	Age
8	1			
	2			
	3	Walter Kruger child	1941	
	4			
	5	Helena Krahn	1949	
	6	Margareta Tiesson	16 Apr 1938	2 yrs 9 mos
	7	Margareta Tiesson	20 Jun 1933	2 mos 11 days
	8	Peter Friesen	13 Jan 1938	84 yrs
9	1	Annie Rolston McClenaghan	25 Nov 1914	50 yrs
	2	George McClenaghan	04 Dec 1948	57 yrs
	3	Mrs Geo. McClenaghan		
	4	John McClenaghan	13 Aug 1932	78 yrs
	5			
	6			
	7			
	8	Walter (McClenaghan)	19 Apr 1919	24 yrs
10	1	J.B. Henry	14 Jul 1907	52 yrs
	2	Samuel E Henry	30 Sep 1947	45 yrs
	3	Margaret M. Robinson	16 Feb 1936	13 yrs 3 mos
	4	Mrs J.B. (Sarah) Henry	24 Apr 1953	86 yrs
	5	John James Henry	01 Aug 1975	80 yrs
	6			
	7	Annie (Henry) Robinson	28 Apr 1932	41 yrs
	8	Marjorie Emma Henry	07 May 2003	100 yrs
11	1			
	2			
	3			
	4			
	5	Anna Klassen	06 Feb 1945	74 yrs
	6			
	7			
	8			
12 - 24	1			
	2			
	3			
	4	ALL VACANT		
	5			
	6			
	7			
	8			

Plot data from cemetery records cont.

Plot #	Subplot	Person buried	Date of burial	Age
25	1	Ronald Johnston Sclater	27 Mar 1979	25 yrs
	2			
	3			
	4 CW	Albert Ward Sclater	28 Dec 2007	86 yrs
	4 CE	Mary Marjorie (Johnston) Sclater	10 Apr 2012	83 yrs
	5			
	6			
	7			
26	1	Peter Macdonald	11 Aug 1943	66 yrs
	2	Victor C. Martin	12 Aug 1951`	71 yrs
	3 CW	Peter Robertson MacDonald	31 Jul 2019	93 yrs
	3 CE	Charlotte Mary MacDonald	24 Jul 2020	93 yrs
	4	Margaret Jane MacDonald	14 Jul 1972	87 yrs
	5			
	6			
	7	Phillip Prokapow		
27	8	Storozuk baby	06 Mar 1939	
	1	William Brewer	17 Sep 1904	23 yrs
	2			
	3			
	4 CW	Lillian Inkster (Sclater) Kennell	12 Sep 1997	80 yrs
	4 CE	Roland Kennell	30 Sep 2000	82 yrs
	5	Jessie Thompson Sclater	13 Mar 1970	74 yrs
	6			
28	7	Leonard Crampaine	16 Jul 1940	19 yrs
	8	Ronald Ward Sclater	21 May 1940	56 yrs 9 mos
	1	Ernest Wm Sparling	21 Oct 1903	10 yrs
	2	Albert Madden	05 Dec 1963	88 yrs
	3	Mrs Albert (Lillian) Madden	14 Mar 1962	81 yrs
	4	Mrs Stuart (Gladys) Madden	19 Jan 1951	36 yrs
	4 CW	Wayne Edgar Madden	17 Jul 2016	74 yrs
	5	Stuart Wilbur Madden	28 Apr 1993	81 yrs
	5CW	Winnifred Louise Madden	10 May 2025	97 yrs
	6 CW	Barry Lee Madden	28 Jan 2010	70 yrs
	7			
	8			

Plot data from cemetery records cont.

Plot #	Subplot	Person buried	Date of burial	Age
29	1			
	2	Dorothy Jean Fee	29 Aug 1920	17 yrs
	3	George Arthur Fee	18 Sep 1912	16 yrs
	4			
	5			
	6	Margaret Eunice Fee	05 Sep 1912	11 yrs
	7	Kathleen Fee	08 May 1908	3 mos
	8			
30	1	Elizabeth Kerr Greenlay	26 May 1918	73 yrs
	1 CW	Findlay Stewart Galbraith	27 Aug 2009	91 yrs
	2	Nichol baby		
	3			
	4	Galbraith baby (Jimmy's twin)	23 May 1924	
	5			
	6			
	7,8			
31	1	Edith Merlyn Paddock	16 Feb 1942	1 yr 11 mos
	2			
	3			
	4	Martin Ernest Paddock	04 Dec 1958	15 yrs 7 mos
	5	Bethia Cunningham (Kelly) Paddock	10 Jan 2002	91 yrs
	6			
	7 CW	Kenneth George Paddock	1 June 2024	87 yrs
	8	Martin John Paddock	03 Dec 1997	88 yrs
32	1			
	2			
	3			
	4			
	5	VACANT		
	6			
	7			
	8			
33	1			
	2	Robert McLeod Twigge	30 Jan 1985	68 yrs
	2W	Maybelle Chapleau (Daughter)		
	3	Zella Mildred Twigge	26 Jul 2016	96 yrs
	3W	Sgt Barry Robert (Son) 1945-2May2018		73 yrs
	4			
	5			
	6			
	7			
	8			

Plot data from cemetery records cont.

Plot #	Subplot	Person buried	Date of burial	Age
34	1	George Lawrence Pettapiece	23 Feb 1983	73 yrs
	2 CW	Ronald Keith Pettapiece	16 Oct 2010	84 yrs
	2 CE	Helen Clarinda (Taylor) Pettapiece	21 Dec 2013	86 yrs
	3			
	4	Sadie Julia Elva (MacDonald) Pettapiece	17 Jun 1981	62 yrs
	5 CW	Michael George Lefebvre	11 Oct 2020	59 yrs
	5	Anne Louise (Pettapiece) Lefebvre		
	6			
35	7			
	8			
	1			
	2			
	3			
	4	VACANT		
	5			
36	6			
	7&8			
	1			
	2	Arthur Donald McKinnon	09 Jul 1976	83 yrs
	3	Adeliade Mildred McKinnon	22 Dec 1973	77 yrs
	4			
	5			
37	6 CW	June Bessie (Cramer) McKinnon	26 Aug 2009	74 yrs
	6 CE	Lionel Alexander McKinnon	21 Oct 2015	79 yrs
	7&8			
	1	John Brown	21 Nov 1930	65 yrs
	2			
	3	Margaret (Ede) Brown	28 Jul 2015	95 yrs
	4	Mrs J. (Annie) Brown	17 Apr 1950	82 yrs
38	5	Charles H. Bell	13 Jun 1960	72 yrs 11 mos
	6	Joshua Hiram Brown	01 Feb 1989	87 yrs
	7	Wesley R. Brown	29 Sep 1969	25 yrs
	8	Margaret Annie Bell	03 Jul 1970	80 yrs
	1	Richard English	23 Apr 1924	78 yrs
	2	Verna Margaret English	23 Jan 1930	9 mos 17 days
	3			
38	4	Mrs. R. (Margaret Berry) English	09 Aug 1934	82 yrs
	5			
	6			
	7			
	8			

Plot data from cemetery records cont.

Plot #	Subplot	Person buried	Date of burial	Age
39	1			
	2	Leslie Matthias Pettapiece	15 Feb 1969	62 yrs
	2 CW	Leslie-Anne Purdy	02 Aug 1981	baby
	2 CW	Anne Wilhemina (Henderson) Pettapiece	03 Dec 1996	85 yrs
	5,6			
	7 COL	Donald R. Devries	Sept, 2021	93 yrs
	7 COL	Shirley E. Devries	Sept, 2021	79 yrs
40	7 COL	Bruce H. T. Devries		
	7 COL	Margaret Jean (Pettapiece) Devries		
	8 CW	William Elgin Pettapiece	29 Jul 2005	89 yrs
	8 CE	Florence Ada (Harvey) Pettapiece	29 Jul 2005	89 yrs
	1	James Ollett	23 Jul 1963	87 yrs
	2			
	3			
41	4	William Ollett	09 Jan 1921	84 yrs
	5	A. (Anne Fletcher) Ollett	11 Feb 1926	88 yrs 11 mo
	6			
	7			
	8	William Ollett	02 Mar 1955	90 yrs
	1	Ivy Elenor (Ollett)	22 Sep 1918	12 yrs
	2	Mundell baby		
42	3	William James Ollett	12 Dec 1947	30 yrs 2 mos
	4	May Ollett	13 Jan 1932	53 yrs
	5	Robert Ollett	05 Jul 1962	84 yrs
	6	Evaline Mundell	21 Jan 1988	83 yrs
	7	William James Mundell	30 Sep 1985	75 yrs
	8			
	1	Almira Jane Bollman	23 Jan 1939	51 yrs 7 mos
42	2	Albert James (Bollman)	1917	Infant
	3	Stanley Frederick (Bollman)	1919	1yr
	4	Frederick William Bollman	02 Feb 1962	75 yrs
	5	Robert Henry Bollman	25 Sep 2010	85 yrs
	6 CW	June Linne (Oklund)Bollman	11 Sep 2010	87 yrs
	6 CE	Franklin Wilfred Bollman	11 Oct 2013	91 yrs
	7	Laura Bell	13 Mar 1924	1 yr
42	8	Georgina Viola (Dale) Bollman	28 Jun 2018	91 yrs

Plot data from cemetery records cont.

Plot #	Subplot	Person buried	Date of burial	Age
43	1	Frederick William Giles	13 Apr 1955	84 yrs 7 mos
	2			
	3			
	4	Janet Butter (Pettapiece) Giles	13 Feb 1947	65 yrs 4 mos
	5 CW CE	Reid Melville Spearin Lillian Minto (Giles) Spearin	1980 4 Mar 2000	66 yrs 90 yrs
	6			
	7	Soldan child		
	8	William Brough	31 Dec 1940	74 yrs 9 mos
44	1	Clackson baby (Geo Ruskin)	02 Apr 1899	2 mos
	2	Brian Moore Wolstenholme	19 Jun 1938	26 days
	3	William Kaye Wolstenholme Sharon Phyllis (White) Wolstenholme		
	4			
	5			
	6	Vera Hazel (Pettapiece) Wolstenholme	13 Jun 1973	69 yrs
	7	Henry (Harry) Samuel Wolstenholme	22 Jan 1971	69 yrs
	8			
45	1	W. Gilpin		
	2	Geo Gilpin	26 Feb 1935	75 yrs
	3			
	4			
	5 CW	William James Douglas Spearin Margery Anne (Lutes) Spearin	09 Jan 2002	78 yrs
	6			
	7	J. Henry Smith	15 Jan 1942	63 yrs
	8			
46	1	Peter Robertson		
	2	Christina (Ferguson) Robertson (wife)		
	3	Magnus Robertson (son)		
	4	Mrs MacDonald (sister)		
	5			
	6			
	7			
	8			

Plot data from cemetery records cont.

Plot #	Subplot	Person buried	Date of burial	Age
47	1			
	2			
	3			
	4			
	5			
	6			
	7	Hannah McKeller	30 Dec 1894	74 yrs
	8	Cecil Jackson Spearin Edna Doreen (Brynelson) Spearin	30 Jun 2011 13 May 2017	93 yrs 96 yrs
48	1	Irene Spence Pettapiece	28 Nov 1951	68 yrs
	2	Elgin Robertson	13 Jul 1938	
	3			
	4	William John Pettapiece	13 Oct 1933	57 yrs
	5	Margaret Minto Pettapiece	17 Nov 1915	70 yrs
	6	Susan Muir Pettapiece	29 Oct 1942	68 yrs
	7	Gwendolyn Mabel Pettapiece	19 Sep 1922	1yr 17 days
	8	Matthias Pettapiece	18 Aug 1912	67 yrs
49	1	Williamm Kaye Wolstenholme	26 Sep 1936	67 yrs
	2	Thomas Wolstenholme	16 Nov 1952	82 yrs 7 mos
	3	Ethel Annetta Wolstenholme	16 May 1957	85 yrs
	4	Lola Margaret (Wolstenholme)	1918	3 days
	5	Thomas Joseph Leech	1913	7 yrs
	6 CW	Mary Elfred (Wolstenholme) Switzer	27 Jun 2003	104 yrs
	7	Norman Alfred Wolstenholme	20 Jun 1941	33 yrs
	8	Margery Edna (Wolstenholme)	1907	8 yrs
50	1	Annie Bollman	Dec 1895	45 yrs
	2	(Bollman) baby		
	3	David Bollman	02 Mar 1970	79 yrs
	4	Philip L. Bollman	18 Dec 1895	45 yrs
	5	Mrs. Catherine Bollman	Apr 1923	73 yrs
	6			
	7			
	8			

Plot data from cemetery records cont.

Plot #	Subplot	Person buried	Date of burial	Age
51	1			
	2			
	3			
	4			
	5	Arthur Noble Graham	26 Apr 1990	78 yrs
	6			
	7			
	8	Myrtle Lorna Graham	09 Sep 1966	9 days
52	1	Michael Lamb		
	2	Robert Dennis Lamb	10 Sept 2023	36 yrs
	3			
	4	(Gm) Elizabeth Muir (Linklater)		90 yrs
	5	(Gp) Magnus Linklater		90 yrs
	6	(Grandpa and Grandma and		
	7	infant son of James & Janet Linklater		
	8	in centre of Plot)		
53	1	Ernest C. Linklater	27 Apr 1905	22yrs 7 mos
	2	James Linklater	08 Jun 1905	72 yrs 10 mo
	3	Mrs. Linklater (Janet Campbell)	26 May 1920	73 yrs 3 mos
	4	Charles R. Linklater	02 Feb 1901	21 yrs 3 mos
	5	Milton F. Linklater	Aug 1906	21 yrs
	6			
	7			
	8			
54	1	William Edward Hornibrook	20 Nov 1993	81 yrs
	2			
	3			
	4 CW	Agnes Clara (Short) Hornibrook	20 Aug 2022	108 yrs
	5			
	6			
	7			
	8			
55	1	William Marshall Primmer	01 Jul 1919	34 yrs
	2			
	3			
	4	(Mrs. M) Helen C. Primmer	06 Apr 1966	81 yrs
	5			
	6			
	7 CW 7 CE	Vaughan Stuart Madden Diane Christina (Greenaway) Madden	4 Jul 2015 21 Apr 2019	70 yrs 74 yrs
	8			

Plot data from cemetery records cont.

Plot #	Subplot	Person buried	Date of burial	Age
56	1	Jane (Gray) Greig	05 Jan 1933	76 yrs
	2	James S. Greig	11 Apr 1921	44 yrs
	3	Alex T. Greig	10 Feb 1954	69 yrs
	4	William Duthie Greig	07 Nov 1921	64 yrs
	5	Eileen (Glenn) Corbey		
	6			
	7			
	8 CW	Frank AJK Corbey	3 Nov 2016	65 yrs
57	1	Clara Edith M. (White) (Mrs John) Edwards (sister of Samuel, buried together)	25 Oct 1908	
	2	Samuel J. J. White	25 Oct 1908	23 yrs
	3	Mrs Maria White	Apr 1936	88 yrs 8 mos
	4			
	5	Victor Corbey	28 May 1995	75 yrs
	5 CW	Gabrielle Corbey	15 Aug 2020	97 yrs
	6 CW	Dennis Roy Lamb	27 Dec 2003	53 yrs
	6 CE	Harriet Anne (Corbey) Lamb	17 Jun 2014	66 yrs
	7 CW	Wayne Reynaud	6 Jun 2015	57 yrs
58	8 CW	Christiaan Hendrick Joseph Corbey	23 Feb 2015	90 yrs
	1	Hubert Brown	1910	
	2			
	3			
	4	FULL PLOT ?		
	5			
	6			
	7			
	8			
59	1	Caroline E. Short	22 Oct 1939	68 yrs
	2	George H. Short	19 Oct 1956	81 yrs 11 mos
	3	Esther Elizabeth (Hyndman) Short	15 Jun 1987	99 yrs
	4	Richard R. Short	29 Aug 1963	90 yrs
	5			
	6			
	7			
	8	Lawrence Holwell Short	1 Aug 2016	95 yrs

Plot data from cemetery records cont.

Plot #	Subplot	Person buried	Date of burial	Age
60	1			
	2	Howard M. Spearin	16 Jan 1952	68 yrs
	3	Edna Mildred Spearin	20 Feb 1976	91 yrs
	4	James Spearin	15 Feb 1929	75 yrs
	5	Mary Grace (Spearin)	1906	51 yrs
	6	Kenneth Howard Spearin	26 Oct 1945	28 yrs
	7			
	8	Willie (Spearin)	Sep 1884?	5 yrs
61	1	Walter Howard Graham	17 Sep 1914	50 yrs
	2			
	3	Elizabeth Graham	26 Sep 1967	88 yrs
	4	Janette Graham	23 May 1903	61 yrs
	5	Ephraim Graham	31 Dec 1902	76 yrs
	6	Henry D. Graham	11 May 1934	62 yrs
	7	Russell Lorne Graham	05 Jan 1935	27 yrs
	8	Laura Graham	05 Jun 1882	13 yrs
62	1			
	2			
	3			
	4	Robina E. Grummett	12 Mar 1924	23 yrs
	5	Samuel Grummet	30 Oct 1918	67 yrs
	6			
	7	Ada Emily Field (Grummett)	21 Aug 1922	33 yrs
	8	Mrs Samuel (Jean (Jane) Pender Shanks) Grummett	08 Aug 1902	49 yrs
63	1	James Lawson Kelly	20 Aug 1902	16 yrs
	2	Geoge Bender Kelly	17 Mar 1942	85 yrs 11 mo
	3	Mary Ellen (Crosbie) Kelly	05 Jan 1955	75 yrs 7 mos
	4	Jennie (Jean Shanks) Kelly	30 Nov 1904	6 mos
	5	Mary Ellen (Shanks) Kelly	13 Aug 1901	45 yrs
	6	Ellen Robina Kelly	19 Dec 1906	14 yrs
	7	Albert E. Kelly (bro)	20 May 1883	31 yrs
	8	John Doan Kelly	11 May 1971	88 yrs

Plot data from cemetery records cont.

Plot #	Subplot	Person buried	Date of burial	Age
64	1			
	2	Charles Frederick Haight	25 Dec 1907	46 yrs
	3	Elizabeth (Shanks) Haight	08 Feb 1902	69 yrs
	4			
	5			
	6			
	7			
	8			
65	1	Caroline Kahler	26 May 1905	74 yrs
	2	Gilbert Moore Wolstenholme	27 Aug 1979	65 yrs 11 mo
	3	Muriel Eileen (Watt) Wolstenbolme	19 Aug 1996	85 yrs
	4	Margaret (Shanks) Kahler	25 Jun 1943	86 yrs
	5	Peter Kahler	12 Feb 1957	90 yrs
	6	Mary Muriel (Rose) Wolstenholme	23 Jun 2003	91 yrs
	7	Allan Elgin Garth Wolstenholme	04 Dec 1979	69 yrs
	8			
66	1	Thomas Moore & Sarah Howe (Powers) Moore	26 May 1896 17 Apr 1896	81 yrs 79 yrs
	2	Samuel Wilkenson (Moore)	17 Feb 1911	66 yrs
	3	Mary Jane (Ulliot) Moore	17 Jan 1935	89 yrs
	4	Alonzo Ezra Moore	30 Apr 1895	22 yrs
	5	Ernest Moore	31 Dec 1882	2 yrs
	6			
	7	William Martin Moore	08 Jan 1894	19 yrs
	8	George Herbert Moore	17 Jul 1893	1 yr 10 mos
67	1	Nettie Amelia Near	20 Feb 1891	5 yrs
	2			
	3			
	4	Alice May Near	07 Aug 1897	7 yrs
	5	Harold William Near	23 Apr 1899	13 mos
	6			
	7	Wooden marker		
	8			

Plot data from cemetery records cont.

Plot #	Subplot	Person buried	Date of burial	Age
68	1 CW	Lorne Murray Radcliffe	21 Mar 2021	86 yrs
	2	John Webb? Radcliffe	25 Nov 1980	83 yrs
	3	Clara Alice Radcliffe	19 May 1993	86 yrs
	4	Frances Arlene (Philp) Radcliffe		
	5			
	6	Margaret Ann Radcliffe "Bob" Robert Radcliffe (monument only)	26 Mar 1942	82 yrs 88 yrs
	7	John Radcliffe	1906	
	8			
69	1	A. McKinnon baby		
	2			
	3			
	4			
	5	Margaret (Cadger) McKinnon	06 Jan 1931	65 yrs
	6			
	7			
	8	James Alexander McKinnon	12 Mar 1941	78 yrs
70	1 CW	Norma M. Gill	09 Oct 2020	62 yrs
	2			
	3			
	4	Eunice Elizabeth Gill	21 Dec 1981	54 yrs
	5	Douglas Harland Gill	22 Oct 2011	82 yrs
	6			
	7			
	8 CW	Kenneth H. Gill	26 June 2023	67 yrs
71	1			
	2	Anne Marie (Nychuk) Citulsky	08 Jun 2011	86 yrs
	3	William Citulsky	24 Mar 2012	87 yrs
	4			
	5			
	6	Michael Lotocki	20 Jan 1986	81 yrs
	7			
	8			

Plot data from cemetery records cont.

Plot #	Subplot	Person buried	Date of burial	Age
72	1			
	2			
	3			
	4			
	5	William Watt	28 Jan 1951	89 yrs
	6			
	7			
	8	Margaretta Watt	Oct, 1910	47 yrs
73	1			
	2	Clair E. Grant	1910	
	3			
	4 CW	James Gordon Shanks	04 Sep 2000	89 yrs
	4 CE	Martha Myrtle Shanks	27 Jul 2005	89 yrs
	5	Kathleen Myrtle Shanks		
	6			
	7			
74	1			
	2	John Mortimer	25 Mar 1918	3 yrs
	3			
	4			
	5			
	6			
	7			
	8			
75	1	John Playfair Stratford	26 Sep 1957	81 yrs
	2			
	3			
	4	May (Ritchie) Stratford	16 Jul 1956	72 yrs 11 mos
	5	Evelyn Agnes Minto (Pettapiece) Stratford	10 Feb 1995	77 yrs
	5 CW	James Lawrence (Larry) Stratford	23 Jul 2016	59 yrs
	6			
	7			
	8	James Ritchie Stratford	28 Jan 1998	89 yrs

Plot data from cemetery records cont.

Plot #	Subplot	Person buried	Date of burial	Age
76	1	James Snowden	21 Aug 1908	11 yrs
	2	George Wilfred Snowden	27 Aug 1993	84 yrs
	3	Eileen C. Snowden	18 Feb 1972	58 yrs 9 mos
	4	Ernest (Snowden)	02 Jun 1919	23 yrs
	5	Mary Anne Snowden	25 Jun 1956	89 yrs
	6	Martha Snowden	07 Jan 1974	76 yrs
	7	Robert Snowden	25 Feb 1976	81 yrs
	8	James J. Snowden	28 Jul 1946	80 yrs 10 mos
77	1	Mary Kroft Kahler	08 Sep 1960	81 yrs
	2			
	3			
	4	Conrad Kahler	09 Feb 1953	83 yrs
	5	Euphemia (Thompson) Kahler	1908	
	6			
	7			
	8			
78	1	James Shanks	Nov 1912	67 yrs
	2	Robert Crosbie Shanks	06 Jun 1952	68 yrs
	3	Norma Hazel (Johnson) Shanks	02 May 1974	76 yrs
	4	Thomas Shanks	23 Mar 1916	75 yrs
	5	Margaret A. (Tingle) Shanks	13 Jun 1920	
	6	Ida F. (Wrigglesworth) Shanks	29 Apr 1933	64 yrs
	7	John T. Shanks	23 Aug 1945	72 yrs
	8			
79	1			
	2			
	3	A&F Shanks baby (Charlie)	07 Feb 1934	
	4	Rachel Maude (Willcott) Shanks	23 Mar 1970	96 yrs
	5	Thomas Shanks	23 Nov 1945	76 yrs 7 mos
	6 CW	Thomas Lorne Shanks	20 Nov 1998	85 yrs
	6 CE	Margaret Cameron (Greig) Shanks	30 Sep 2020	103 yrs
	7	Elizabeth Willcott	12 Feb 1920	84 yrs
	8	William G. Shanks (monument only)		

Plot data from cemetery records cont.

Plot #	Subplot	Person Buried	Date of burial	Age
80	1	John Shanks	09 May 1959	97 yrs 9 mos
	2			
	3 CW	Laura Shanks	24 Jul 1996	
	4	(Mrs. John) Annie (Graham) Shanks	13 Jan 1948	81 yrs 7 mos
	5	Graham Lawson Shanks	20 Jun 1983	93 yrs
	6	John Edward Graham (Ted) Shanks No burial	3 Feb 1979	54 yrs
	7	William Pender Shanks	04 May 1970	76 yrs
	8	Mildred Grace (Spearin) Shanks	17 Feb 1934	43 yrs?
81	1	William Shanks	08 Aug 1901	86 yrs
	2	Robina Euing (Shanks) Graham	05 Jul 1913	48 yrs
	3	Arthur Oswald Graham	16 Nov 1932	74 yrs
	4	Ellen (Helen) (Lawson) Shanks	06 May 1908	80 yrs
	5	James William Shanks	04 Apr 1914	65 yrs
	6			
	7			
	8	Ann (Annie) Shanks	06 Apr 1931	80 yrs

Mrs Menzie buried in pathway opposite the SE corner of plot 65

Explanatory Notes

1. When a maiden surname is given it is put in parenthesis.
2. When the married surname is not given but is known, it is put in parenthesis.
3. When only given names are listed, the surname, if known, is put in parenthesis.
4. Dates given are generally for burial but occasionally may be dates of death.

3. MONUMENTAL (TOMBSTONE) INSCRIPTIONS

(Pettapiece Cemetery recordings – Aug 2006 to Aug 2022)

Plot # 1	
	F/O Graham KITE / son of G. and J KITE Born Feb. 18, 1922 Killed in action Sept. 24, 1944 Grave in Belgium
	George Robert KITE Born Bath, Eng. Dec 15, 1887 Died Deer Lodge July 11, 1960. Janette Burnett SHANKS Born Pettapiece, Manitoba June 4, 1892 Died Winnipeg Feb. 28, 1977
	Victor S. KITE Driver, Royal Artillery 19 Jan 1957, Age 59
	HURLEY Marianne Janette (Kite) July 18, 1926 – February 8, 2015 Loving Mother of Graham, John and Paul
	SHANKS Doreen Patricia (Kite) February 16, 1928 – May 7, 2023 Loving Mother of Bob and Ann
	Capt. John Lawson KITE August 29, 1929 – January 22, 2023
Plot # 3	Gladys Linder(?) Edna SNUGGS Daughter of Arthur and Mary SNUGGS Died 14 Jan 1910 Aged 6 years and 10 months
Plot # 4	E. TAIT - Welded metal marker
Plot # 8	Helena KRAHN – Mother 1879 - 1949
	Margareta TIESSEN April 6, 1933 - June 17, 1933
	Margareta TIESSEN June 19, 1935 – Apr 14, 1938
	Walter KRUEGER – 1841 - Infant

Plot # 9	<p>John McCLENAGHAN Died Aug 13, 1932 Aged 78 years</p> <p>Annie ROLSTON / Wife of John McCLENAGHAN Died Nov 25, 1914 Aged 50 years</p>
	<p>George (McClenaghan) Born May 18, 1891 Died Dec 2, 1948</p>
	<p>Minnie (McClenaghan?) Born Jan 7, 1900 Died May 11, 1979</p>
	<p>Robert McClenaghan Born Feb 22, 1893 Died Mar 4, 1980</p>
	<p>Walter McClenaghan Born Apr 6, 1895 Died Apr 19, 1919</p>
Plot # 10	<p>John B. HENRY Died July 14, 1907 Aged 52 yrs and 1 month</p>
	<p>Sarah HENRY 1867 - 1953</p>
	<p>Samuel E. HENRY Born May 24, 1902 Died Sept 27, 1947</p>
	<p>John J. HENRY 1894 – 1975</p> <p>Marjorie E. Henry 1903 – 2003</p>
	<p>Annie H. HENRY / wife of W.D. ROBINSON Died Apr 27, 1932 Aged 41 years</p>
	<p>Margaret M. ROBINSON 1923 - 1936</p>

Plot # 25	Ronald Johnston SCLATER July 20, 1954 – Mar 21, 1979
	Albert Ward (Abe) SCLATER July 5, 1921 – Dec. 22, 2007 Mary Marjorie (Johnston) SCLATER Sept. 26, 1928 - Apr 2, 2012 Parents of Tom, Ron, Aeleen
Plot # 26	Margaret Jane MacDONALD 1885 - 1972
	Peter MacDONALD
	Victor C. MARTIN Corporal 27 Battn. CEF 10 Aug 1951 – Age 71
	Peter Robertson “Bob” MacDonald Jan 22, 1926 – Jan 22, 2019 Charlotte Mary (Toth) MacDonald Oct 27, 1927 – Dec 24, 2019
Plot # 27	S / Sergeant Ronald W. SLATER(sic) 28 th Batt. RCA B.E. F. 1883 - 1940
	William BREWER Of Burton-on-Trent, Eng. Died at Brandon, Manitoba Sept 17, 1904 Aged 23 years and 3 months
	KENNEL Lillian (nee Sclater) Roland Aug 31, 1916 May 19, 1918 Dec 22, 1996 July 13, 2000
Plot # 28	EVER REMEMBERED EVER LOVED Winnifred MADDEN Stuart W. MADDEN 1926 – 2024 1912 – 1993
	Gladys MADDEN Aug. 6, 1914 - Jan. 15, 1951
	Lillian A. MADDEN - Mother 1880 - 1962 Albert J. MADDEN – Father 1875 - 1963
	Barry Lee Madden April 1, 1939 - Jan. 25, 2010

Plot # 29	Kathleen FEE Died Mar 8, 1908 Aged 3 mos.
	Margaret E. FEE Died Sept 5, 1912 Aged 11 yrs.
	George A. FEE Died Sept. 18, 1912 Aged 16 yrs. Children of W.M. and J.D. FEE
	Dorothy J. FEE Died Aug 29, 1920 Aged 17 yrs and 8 mos
Plot # 30	Elizabeth Kerr GREENLAY May 1845 – May 1918
	Unnamed Boy GALBRAITH May 16, 1924 – May 23, 1924
	William David GALBRAITH Oct 7, 1913 – Nov 20, 1944 Schoonselhof Cemetery, Antwerp, Belgium
	William GALBRAITH June 10, 1867 – March 17, 1944 Loving husband of Ruth Rachel GREENLAY April 1, 1883 – Nov 28, 1952
	Ernest (Jimmy) GALBRAITH May 16, 1924 – July 1, 2002 Three Above Buried at Quill Lake, Sask.
	John Francis GALBRAITH May 11, 1915 – Oct. 30, 1983 Buried at Lloydminster, Sask.
	Findlay Stewart GALBRAITH June 16, 1917 – Apr 8, 2009

Plot # 31	Martin J. PADDOCK – Father 1909 - 1997
	Bethia C. PADDOCK – Mother 1910 - 2002
	Ernest PADDOCK – Son 1943 - 1958
	E. Merlyn PADDOCK – Daughter 1940 - 1942
	Kenneth George Paddock (no monument yet June2024) 15 May 1937 – 27 April 2024
Plot # 33	Zella M.TWIGGE Robert M. TWIGGE 1920 – 2016 1916 - 1985
Plot 33	<div>BELOVED</div> <div> <div>Son</div> <div>Barry</div> <div>1945 - 2018</div> </div> <div> <div>Daughter</div> <div>Maybelle</div> </div>
Plot #34	L. George PETTAPIECE 1910 - 1983 Sadie PETTAPIECE 1918 - 1981
	R Keith PETTAPIECE 1926 - 2010 Helen C (TAYLOR) PETTAPIECE 1927 – 2013
	<div>LEFEBVRE</div> <div> <div>Michael G.</div> <div>Aug 14, 1961 - Oct 1, 2020</div> </div> <div> <div>Anne L. (Pettapiece)</div> <div>Apr 9, 1959 -</div> </div>
Plot # 36	Arthur D. McKINNON 1893 - 1976
	Adeliade M. McKINNON 1896 - 1973
	<div>McKINNON</div> <div> <div>Lionel Alexander</div> <div>Jan 21, 1936</div> <div>Oct 15, 2015</div> </div> <div> <div>June Bessie</div> <div>Jan 22, 1934</div> <div>Jan 6, 2009</div> </div>

Plot # 40	<p>William A. OLLETT 1837 – 1921</p> <p>Annie FLETCHER 1837 – 1925</p> <p>William OLLETT 1864 – 1955</p> <p>James OLLETT 1876 - 1963</p>
Plot # 41	<p>Robert OLLETT 1878 - 1962</p>
	<p>W. J. Jim MUNDELL 1910 – 1985</p> <p>Evaline MUNDELL 1905 - 1989</p>
Plot # 42	<p>Frederick William BOLLMAN 1886 - 1962</p> <p>Almira Jane BOLLMAN 1887 – 1939</p> <p>Albert James BOLLMAN – Infant - 1917 Stanley F. BOLLMAN –1918 - 1919</p>
	<p>Robert H. BOLLMAN 1924 - 2010</p> <p>Georgina V. BOLLMAN 1926 - 2018</p>
	<p>Franklin W. BOLLMAN Mar. 10, 1922 – Oct. 5, 2013</p> <p>June L. BOLLMAN June 10, 1923 - Aug. 19, 2010</p>

Plot # 43	William BROUGH Born Mar 1867 Died Dec 29, 1940
	Janet GILES 1881 – 1947 Frederick GILES 1870 - 1955
	Reid M. SPEARIN 1913 – 1980 Lillian M. SPEARIN 1909 - 2000
Plot # 44	Harry S. WOLSTENHOLME 1902 – 1971 Vera H. WOLSTENHOLME 1904 - 1973
	Brian M. WOLSTENHOLME May 24, 1938 – June 18, 1938
	George Ruskin CLACKSON – Infant son Apr 2, 1899. Aged 2 mo.
Plot # 45	SPEARIN William James “Douglas” Margery Anne (Lutes) Feb 5, 1923 – Jan 5, 2002 Oct 10, 1927 – Parents of James D., Howard K., W. Glenn
	Henry J. SMITH Born March 14, 1879 Died Jan 13, 1942
Plot # 46	C. FERGUSON Wife of Peter ROBERTSON Died 20 Jan 1896 52 – Native of Leith, Scotland

Plot # 47	Hannah (McKELLAR) Wife of John McKELLAR Died Dec 20, 1894 Age 74 years
	SPEARIN Cecil Jackson Edna Doreen (Brynelson) Nov 27, 1918 Oct 26, 1921 Jan 10, 2011 Jan 17, 2017
Plot # 48	Matthias PETTAPIECE Born June 8, 1845 – Died Aug 18, 1912 – 67 yr His wife Margaret Minto PETTAPIECE Born Mar 23, 1845 – Died Nov, 17, 1915 – 70 yr
	Susan M. PETTAPIECE 1874 - 1942
	Daniel Hewitt Rodger PETTAPIECE Son of Matthias and Margaret M. PETTAPIECE Died Mar 22, 1889 at North Gower Village, Carlton(sic) Co. Ontario Aged 3 yrs 5 mo
	William John PETTAPIECE Born Aug 27, 1876 – Died Oct 11, 1933 His wife Irene S. ROBERTSON 1894 - 1951
	Gwendolyne Mabel PETTAPIECE Born Aug 30, 1921 – Died Sept 17, 1922

Plot # 49	<p>Thomas WOLSTENHOLME April 6, 1870 – Nov 16, 1952</p> <p>His wife Ethel A. MOORE Oct 28, 1873 – May 13, 1957</p>
	Norman A. WOLSTENHOLME 1907 – 1941
	Margery WOLSTENHOLME 1899 - 1907
	Lola WOLSTENHOLME Aged 3 dys - 1918
	Leech WOLSTENHOLME Aged 7 yrs - 1913
	William Kaye WOLSTENHOLME 1869 - 1936
	Mary Elfred (WOLSTENHOLME) SWITZER Jun 25, 1898 – Jun 24, 2003
Plot # 50	<p>Philip L. BOLLMAN Born Nov 18, 1850 – Died Dec 21, 1895</p> <p>His Wife Catherine BOLLMAN Born Nov 28, 1850 – Died Apr 16, 1923</p>
	David BOLLMAN Mar 6, 1891 – Feb 23, 1970
Plot # 51	A. Noble GRAHAM 1911 - 1990
	Myrtle L. GRAHAM Aug 29 – Sept 6, 1966

Plot 52	Robert Dennis Lamb (no monument yet Sept2023)) 6 July 1986 – 22 February 2023
Plot # 52	Magnus LINKLATER - Aged 90 years His Wife Elizabeth MUIR – Aged 90 years
	James LINKLATER Died June 8, 1905 – Aged 72 years and 10 mo. His Wife Janet CAMPBELL Died May, 26, 1920 – Aged 73 years and 3 months
	Charles R. LINKLATER Died Feb 2, 1901 Aged 21 years and 2 months and 10 days
	Ernest C. LINKLATER Died Apr 27, 1905 Aged 22 years, 7 months and 7 days Children of James and J LINKLATER Milton F. LINKLATER Died Aug, 1906 Aged 21 Years
Plot # 54	HORNIBROOK William E. Clara (Short) 1912 – 1993 1913 - 2022 Parents of Richard, Carmen, Ruth

Plot # 55	William Marshall PRIMMER Died July 1, 1919 Age 34 years Helen C. PRIMMER 1884 - 1966
	Margaret Agnes DAY nee PRIMMER Dec 6, 1914 – Mar 4, 1994
	MADDEN Vaughan Stuart Dec 8, 1943 Nov 29, 2014 Diane Christina Dec 19, 1943 Dec 9, 2018
Plot # 56	Pte John R. GREIG Died of Wounds In Belgium Nov 20, 1917 Aged 27 Yrs
	James G. GREIG Died Apr 11, 1921 Aged 44 years
	William Duthie GREIG Died Nov 1, 1921 Aged 64 years
	Jane Gray GREIG Died Jan 2, 1933 – 76 yrs
	Alexander T. GREIG (Metal Marker) 1884 - 1954
	CORBEY Frank AJK Jan 28, 1951–Oct 29, 2016 Eileen (Glenn) Jun 18 1958

Plot # 57	Samuel J. J. WHITE Died Oct 25, 1908 – age 23		
	Clara Edith W. WHITE / wife of John W. EDWARDS Died Oct 25, 1908 – age 26 yrs		
	Maria BROWN / wife of James WHITE Born July 25, 1847 – Died Mar 30, 1986		
	Victor F. M. H. CORBEY May 28, 1920 – May 30, 1995	Gabrielle M.D. Aug 15, 1922 - Dec 29, 2019	
	Christiaan Hendrick Joseph CORBEY Jan 25, 1925 – Feb 23, 2015		
	LAMB Dennis Jan 30, 1950 – Dec 23, 2003 – 53 yr		Harriet Sept 10, 1947 – June 17, 2014 – 66 yr
	REYNAUD Wayne R. May 9, 1945 Oct 13, 2005		

Plot # 59	SHORT George H. 1874 – 1956	His wife Esther E. (HYNDMAN) 1874 - 1987
	Caroline E. SHORT 1870 – 1939 Sister	
	Richard R. SHORT 1872 – 1963 Brother	
	SHORT 1920 Lawrence Howell 2016 Husband of Lottie Father of Gerald, Lorna & Norman	

Plot # 60	<p>Mary Grace BRAGG / Wife of James SPEARIN 1855 – 1906</p> <p>James SPEARIN Died Feb 15, 1929 – Age 76 Yr</p>
	<p>Willie SPEARIN / Son of J. and M. SPEARIN Died Sep 20, 1884 – Age 5 yr 3 mo</p>
	<p>Howard M. SPEARIN 1883 – 1952</p> <p>Edna Mildred (REID) SPEARIN 1884 - 1976</p>
	<p>Kenneth Howard SPEARIN 1916 - 1945</p>
Plot # 61	<p>Ephraim GRAHAM Died Dec 31, 1902 – Aged 76 years</p> <p>His Wife Janette DUFF Died May 25, 1903 – Aged 61 years</p>
	<p>Laura GRAHAM / daughter of E. and J. GRAHAM Died June 5, 1882 – Age 13 years 2 mo and 5 days</p>
	<p>Walter Howard GRAHAM Born Sept 14, 1864 – Died Sept 14, 1914</p>
	<p>Henry D. GRAHAM 1872 – 1934</p> <p>Elizabeth GRAHAM 1887 – 1967</p>
	<p>Russell GRAHAM 1907 - 1935</p>
Plot # 62	<p>Samuel GRUMMETT Died Oct 30, 1918 – Aged 67 years and 10 months</p> <p>Wife - Jane Pender SHANKS Died Aug 7, 1902 – Aged 49 years and 4 mo.</p>
	<p>Robina E. GRUMMETT Died Mar 7, 1924 - Aged 34 years</p>
	<p>Ada (GRUMMETT)</p>

Plot # 63	George B. KELLY Died Mar 14, 1942 – Aged 86 years
	Mary SHANKS / Wife of George B. KELLY Died Aug 13, 1901 – Aged 45 years and 7 mo
	Wife – Mary Ellen CROSBIE May 11, 1879 – Jan 2, 1955
	Jennie Shanks KELLY May 17, 1904 – Nov 30, 1904
	James Lawson KELLY Feb 12, 1886 – Aug 20, 1902
	Ellen Robina KELLY Feb 12, 1892 – Dec 19, 1906
	John Doan KELLY Died May 8, 1971 – Aged 88 yrs and 6 mo
	Albert E. KELLY Died May 30, 1883 – Aged 31 yrs
Plot # 64	Elizabeth HAIGHT / Wife of G.F. HAIGHT Died Feb 8, 1902 – Aged 38 years, 8 mo and 7 days
	Charles Frederick HAIGHT Died Dec 25, 1907 – Aged 46 years, 5 mo and 12 days
Plot # 65	Margaret KAHLER / Wife of Peter KAHLER Jan 17, 1857 – Jun 22, 1943
	Peter KAHLER Feb 21, 1867 – Feb 9, 1957
	Caroline KAHLER Died May 26, 1905 – Aged 74 years
	Allan Elgin Garth WOLSTENHOLME 1910 – 1979 Husband of
	Mary Muriel Rose WOLSTENHOLME 1911 - 2003
	Gilbert M. WOLSTENHOLME 1913 - 1979
	Muriel E. WOLSTENHOLME 1911 - 1996

Plot # 66	<p>Samuel W. MOORE Mar 18, 1845 – Feb 17, 1911</p> <p>Wife Mary J. ULLYOT Apr 12, 1845 – Jan 17, 1935</p>
	<p>Ernest H. MOORE Died Dec 31, 1882 – ae 2 yrs and 6 mo</p> <p>George H. MOORE Died Jul 17, 1893 – ae 1 yr and 10 mo</p> <p>Alonzo Ezra MOORE Died April 30, 1895 – ae 22 yr and 6 mo</p> <p>Sons of S.W. and M. J. MOORE</p>
	<p>Thomas MOORE Jan 1, 1817 – May 26, 1896</p> <p>His Wife – Sarah POWERS Mar 11, 1821 – Apr 17, 1896</p>
	<p>William MARTIN Died Jan 8, 1894 – Aged 19 yrs and 3 mo</p>
Plot # 67	<p>No monument for Near family Wooden marker</p>
Plot # 68	<p>John RADCLIFFE 1851 – 1906</p> <p>His wife Margaret Ann WEBB 1860 - 1942</p>
	<p>John Webb RADCLIFFE 1894 – 1980</p> <p>Clara A. RADCLIFFE 1907 - 1993</p>
	<p style="text-align: center;">RADCLIFFE</p> <p style="text-align: center;">Lorne Murray Frances Arlene (Philp) Dec. 30, 1934 – Mar. 18, 2021 Apr. 9, 1939 -</p>
	<p>“Bob” Robert RADCLIFFE 1929 – 2017 (subplot 6, no burial)</p>
Plot 69	<p>Margaret C. MacKINNON Wife of Alexander MacKINNON Dec 23, 1863 – Jan 2, 1931</p> <p>Alexander Mac KINNON Jul 11, 1862 – Mar 9, 1941</p>

Plot # 70	<p>Eunice E. GILL 1927 – 1981</p> <p>Douglas Harland Gill 1929 – 2011</p> <p>Norma M. Gill 24 Jun 1958 – 13 Jan 2020</p> <p>Kenneth H. Gill April 7, 1953 – January 5, 2021</p>
Plot # 71	<p>Mike LOTOCKI Sep 15, 1904 – Jan 15, 1986</p> <p>William (Bill) CITULSKY May 26, 1924 - Mar 21, 2012</p> <p>Anne (Nychuk) CITULSKY Oct 26, 1924 - June 5, 2011</p> <p>Parents of Ron, Evelyn, Michael</p>
Plot # 72	<p>Wm. WATT Died Jan 22, 1951 – Aged 89 years</p> <p>Margaretta WATT 1882 – 1968</p> <p>Margaretta KERR Wife of Wm WATT Died Oct 21, 1910 – Aged 47 years</p>
Plot # 73	<p style="text-align: center;">SHANKS</p> <p style="display: flex; justify-content: space-between;"> Gordon 1910 – 2000 Myrtle 1916 - 2005 </p>
	<p>Kathleen Myrtle SHANKS Oct 15, 1952 Sister of Gerald, Lynne, Mavis, Jack</p>
	<p>Clair E. GRANT 1909 - 1910</p>

Plot # 75	<p>May Ritchie STRATFORD 1883 – 1956</p> <p>John Playfair STRATFORD 1876 – 1957</p> <p>Gibson Ritchie STRATFORD 1919 – 1942 Lost In North Sea</p>
	<p>James R. STRATFORD 1908 – 1998</p> <p>Evelyn A. STRATFORD 1917 – 1995</p>
	<p>STRATFORD 1954 Larry 2015</p>
Plot # 76	<p>James J. SNOWDEN 1864 – 1946</p> <p>Mary Ann SNOWDEN 1967 - 1956</p>
	<p>James SNOWDEN Died Aug 21, 1908 Aged 11 years and 5 months</p>
	<p>Ernest SNOWDEN Died Jun 2, 1919 Aged 23 years and 7 months</p>
	<p>Robert SNOWDEN Mar 10, 1894 – Feb 22, 1976</p> <p>Martha SNOWDEN Mar 27, 1879 – Dec 30, 1973</p>
	<p>Eileen SNOWDEN Jun 13, 1914 – Feb 15, 1972</p>
	<p>George Ronald SNOWDEN 1908 - 1993</p>
Plot # 77	<p>KAHLER 1871 Conrad 1953 1879 Mary Kroft 1960 1865 Euphemia THOMPSON 1908</p>

Plot # 78	<p>Thomas SHANKS Feb 15, 1843 – Mar 21, 1916 A native of Sterlingshire, Scotland</p> <p>His wife Margaret A. TINGLE Mar 17, 1844 – Jun 13, 1920 A Native of Scarboro, Ontario</p>
	<p>James SHANKS Died Nov ,1912 – aged 67 years</p>
	<p>John T. SHANKS Jun 20, 1873 – Aug 20, 1945</p> <p>Ida Florence WIGGLESWORTH / Wife of J.T. SHANKS Dec 3, 1873 – Apr 26, 1938</p>
	<p>Robert Crosbie SHANKS 1886 – 1952</p> <p>Norma Hazel JOHNSON / Wife of Robert C. SHANKS Nov 22, 1897 – Apr 29, 1974</p>
Plot # 79	<p>Thomas SHANKS 1869 – 1945</p> <p>His wife R. Maude WILCOTT 1873 - 1970</p>
	<p>William G. SHANKS (no burial) 1867 - 1944</p>
	<p>Grandma WILCOTT Died Feb 10, 1920 – Aged 83 yrs and 6 mo</p>
	<p>SHANKS Thomas Lorne 1913 – 1998 Margaret Cameron 1916 - 2020</p>
	Baby - Shanks

Plot # 80	<p>John SHANKS 1861 - 1959</p> <p>Annie GRAHAM / Wife of John SHANKS Born Halton Co. Ontario Nov 24, 1866 – Jan 10, 1948</p>
	<p>Graham Lawson SHANKS 1889 – 1983</p> <p>Mildred Grace SPEARIN / Wife of Lawson SHANKS Died Feb 12, 1934</p>
	<p>W. Pender SHANKS 1893 - 1970</p>
	<p>John Edward Graham SHANKS Mar 10, 1924 – Jan 31, 1979</p>
	<p>Laura Elfreda SHANKS Jun 21, 1909 – July 15, 1996</p>
Plot # 81	<p>William SHANKS Born in Lanarkshire, Scotland Aug 31, 1815 Died Aug 6, 1901</p> <p>Ellen LAWSON / Wife of William SHANKS Born in Perthshire Scotland Mar 5, 1828 Died May 4, 1908</p>
	<p>J. W. SHANKS Died Apr 1, 1914 – Aged 64 years, 11 mo</p>
	<p>Ann SHANKS 1851 - 1931</p>
	<p>Robina Euing SHANKS – Wife of Arthur O. GRAHAM Born in Halton Co. Ontario Nov 12, 1865 Died Jul 2, 1913 at Rolla, North Dakota</p> <p>Arthur Oswald GRAHAM 1858 - 1932</p>

Notes

1. Non-historical phrases such as “In God We Trust” have been omitted from this compilation.
2. Spaces between inscriptions indicate location on the same monument (headstone)
Lines within a plot indicate a separate monument .
Blank rows within a plot indicate a plot with “split ownership”.

4. NOMINAL INDEX OF NAMES

The following is an alphabetical index to all names which appear in the monumental (gravestone) inscriptions or the cemetery records for the Pettapiece Cemetery. The format was modified from the publication “Who’s Where – A Guide to the Cemeteries of Rideau Township”¹.

Names, abbreviations, initials or dates and ages in the index generally correspond to those inscribed or listed. When there were differences between sources an attempt was made to clear the discrepancies. If that was not possible a “?” is used to indicate a possible error.

Married women have been indexed under both married and maiden names whenever possible from the information given. When indexed under the married name, the maiden surname appears in brackets after the name in the entry. When indexed under the maiden name, the married surname is underlined in the entry. Where the information is not conclusive, the name has generally been indexed under both surnames with no distinction made in the entry. Errors in judgment that may be revealed undoubtedly will have their origin in such problems of tombstone evidence; for example, a name presumed to be a maiden name may actually be a person’s middle name.

Plot numbers are given as a link to the cemetery records (CR) and monumental inscriptions (MI) files.

SURNAME	GIVEN NAMES	Plot #	CR	MI
BASKERVILLE	Winnifred Louise <u>MADDEN</u>	28	X	X
BELL	Charles H.	37	X	X
	Laura	42	X	
	Margaret Annie (BROWN)	37	X	X
BOLLMAN	Albert James	42	X	X
	Almira Jane	42	X	X
	Annie	50	X	
	baby	50	X	
	Catherine	50	X	X
	David	50	X	X
	Franklin Wilfred	42	X	X
	Frederick William	42	X	X
	June Linne (OKLUND)	42	X	
	Georgina Viola (DALE)	42	X	X
	Philip	50	X	X

¹ Published by the Rideau Heritage Board, Box310 North Gower, Ontario K0A 2T0.

SURNAME	GIVEN NAMES	Plot #	CR	MI
BOLLMAN (cont.)	Robert Henry	42	X	
	Stanley Frederick	42	X	X
BRAGG	Mary Grace <u>SPEARIN</u>	60	X	X
BREWER	William	27	X	
BROWN	Annie (Mrs John)	37	X	X
	Hubert	58	X	
	John	37	X	X
	Joshua Hiram	37	X	X
	Margaret (Ede)	37	X	X
	Margaret Annie <u>BELL</u>	37	X	X
	Maria <u>WHITE</u>	57	X	X
	Wesley R.	37	X	X
BROUGH	William	43	X	X
BRYNELSON	Edna Doreen <u>SPEARIN</u>	47	X	X
CADGER	Margaret <u>McKINNON</u>	69	X	X
CAMPBELL	Janet <u>LINKLATER</u>	53	X	X
CHAPLEAU	Maybelle (TWIGGE)	33		
CITULSKY	Anne Marie (NYCHUK)	71	X	X
CITULSKY	William	71	X	X
CLACKSON	George Ruskin	44	X	X
CORBEY	Christiaan Hendrick Joseph	57	X	X
	Frank A. J. K.	56	X	X
	Harriet Anne <u>LAMB</u>	57	X	X
	Victor F.M.H.	57	X	X
	Gabrielle <u>CORBEY</u>	57	X	X
CRAMER	June Bessie <u>McKINNON</u>	36	X	X
CRAMPAIN	Leonard	27	X	
CROSBIE	Mary Ellen <u>KELLY</u>	63	X	X

SURNAME	GIVEN NAMES	Plot #	CR	MI
DALE	Georgina Viola <u>BOLLMAN</u>	42	X	X
DOWNS	child	3	X	
DUNSMORE	Beatrice	3	X	
DUFF	Janette <u>GRAHAM</u>	61	X	X
EDE	Margaret <u>BROWN</u>	37	X	X
EDWARDS	Clara Edith M. (WHITE)	57	X	X
	John W.	57	X	X
ELLIS	Ethel	2	X	
	child	2	X	
ENGLISH	Margaret Berry	38	X	X
	Richard	38	X	X
	Verna Margaret	38	X	X
FEE	Dorothy Jean	29	X	X
	George Arthur	29	X	X
	J.D.	29		X
	Kathleen	29	X	X
	Margaret Eunice	29	X	X
	W.M.	29		X
FERGUSON	Christina <u>ROBERTSON</u>	46	X	X
FORMAN	child	3	X	
FRIESEN	Peter	8	X	
GALBRAITH	baby	30	X	X
	Ernest (Jimmy)	30		X
	Findlay Stewart	30	X	X
	John Francis	30		X
	Ruth Rachel (GREENLAY)	30		X
	William	30		X
	William David	30		X

SURNAME	GIVEN NAMES	Plot #	CR	MI
GILES	Frederick William	43	X	X
	Janet Butter (PETTAPIECE)	43	X	X
	Lillian M. <u>SPEARIN</u>	43	X	X
GILL	Douglas Harland	70	X	X
	Eunice Elizabeth	70	X	X
	Norma M.	70	X	X
	Kenneth H.	70	X	X
GILPIN	George	45	X	
	W.	45	X	
GRAHAM	Annie <u>SHANKS</u>	80	X	X
	Arthur Noble	51	X	X
	Arthur Oswald	81	X	X
	Elizabeth	61	X	X
	Ephraim	61	X	X
	Henry D.	61	X	X
	Janette (DUFF)	61	X	X
	Laura	61	X	X
	Myrtle Lorna	51	X	X
	Robina Euing (SHANKS)	81	X	X
	Russell Lorne	61	X	X
	Walter Howard	61	X	X
GRANT	Clair E.	73	X	X
GRAY	Jane <u>GREIG</u>	56	X	X
GREENAWAY	Diane Christina <u>MADDEN</u>	55	X	X
GREENLAY	Elizabeth Kerr	30	X	X
	Ruth Rachel <u>GALBRAITH</u>	30		X

SURNAME	GIVEN NAMES	Plot#	CR	MI
GREIG	Alexander T.	56	X	X
	James G.?	56	X	X
	Jane (GRAY)	56	X	X
	John R.	56		X
	William Duthie	56	X	X
	Margaret Cameron <u>SHANKS</u>	79	X	X
GRUMMETT	Ada Emily Susan	62	X	
	Jane Pender (SHANKS)	62	X	X
	Robina E.	62	X	X
	Samuel	62	X	X
HAIGHT	Charles Frederick	64	X	X
	Elizabeth (SHANKS)	64	X	X
HAIYUCK	child	2	X	
HARVEY	Florence Ada <u>PETTAPIECE</u>	39	X	X
HENDERSON	Anne Wilhemina <u>PETTAPIECE</u>	39	X	X
HENRY	Annie H. <u>ROBINSON</u>	10	X	X
	John B.	10	X	X
	John James	10	X	X
	Marjorie Emma	10	X	X
	Samuel E.	10	X	X
	Sarah	10	X	X
HORNIBROOK	William Edward	54	X	X
HORNIBROOK	Agnes Clara (SHORT)	54	X	X
HURLEY	Marianne Janette (KITE)	1	X	X
HYNDMAN	Ester Elizabeth <u>SHORT</u>	59	X	X
JOHNSON	Norma Hazel <u>SHANKS</u>	78	X	X
JOHNSTON	Mary Marjorie <u>SCLATER</u>	25	X	X

SURNAME	GIVEN NAMES	Plot #	CR	MI
KAHLER	Caroline	65	X	X
	Conrad	77	X	X
	Euphemia (THOMPSON)	77	X	X
	Margaret (SHANKS)	65	X	X
	Mary Kroft	77	X	X
	Peter	65	X	X
KELLY	Albert E.	63	X	X
	Ellen Robina	63	X	X
	George B.	63	X	X
	James Lawson	63	X	X
	Jennie Shanks	63	X	X
	John Doan	63	X	X
	Mary Ellen (CROSBIE)	63	X	X
	Mary Ellen (SHANKS)	63	X	X
	Bethia Cunningham <u>PADDOCK</u>	31	X	X
KENNEL	Lillian Inkster (SCLATER)	27	X	X
	Roland	27	X	X
KERR	Margaretta <u>WATT</u>	72	X	X
KITE	Doreen Patricia <u>SHANKS</u>	1	X	X
	George Robert	1	X	X
	G.R. Graham	1		X
	Janette Burnett (SHANKS)	1	X	X
	Victor S.	1	X	X
	Capt. John Lawson (monument only)	1	X	X
HURLEY	Marianne Janette (KITE)	1	X	X
KLASSEN	Anna	11	X	
KRAHN	Helena	8	X	X
KRUEGER	Walter	8	X	X

SURNAME	GIVEN NAMES	Plot #	CR	MI
LAMB	Dennis Roy	57	X	X
	Harriet Anne (CORBEY)	57	X	X
	Robert Dennis	52	X	
LAWSON	Ellen <u>SHANKS</u>	81	X	X
LEECH	Thomas Joseph	49	X	X
LEFEBVRE	Michael George	34	X	X
LINKLATER	Charles R.	53	X	X
	Elizabeth (MUIR)	52	X	X
	Ernest C.	53	X	X
	Infant son	52	X	X
	James	53	X	X
	Janet (CAMPBELL)	53	X	X
	Magnus	52	X	X
	Milton F.	53	X	X
LOTOCKI	Michael	71	X	X
LUTES	Margery Anne <u>SPEARIN</u>	45		
MacDONALD	Charlotte Mary (TOTH)	26	X	X
	Margaret Jane (VOUSDEN)	26	X	X
	Peter	26	X	X
	Peter Robertson (Bob)	26	X	X
McDONALD	Mrs. McDonald (Robertson)	46	X	
MADDEN	A. Lillian	28	X	X
	Albert	28	X	X
	Barry Lee	28	X	X
	Diane Christina (GREENAWAY)	55	X	X
	Gladys	28	X	X
	Stuart Wilbur	28	X	X
	Vaughan Stuart	55	X	X
	Wayne Edgar	28	X	
	Winnifred Louise (BASKERVILLE)	28	X	X

SURNAME	GIVEN NAMES	Plot #	CR	MI
MARTIN	Victor C.	26	X	X
	William	66	X	X
McCLENAGHAN	Annie (ROLSTON)	9	X	X
	George	9	X	X
	John	9	X	X
	Minnie	9		X
	Mrs George	9	X	
	Robert	9		X
	Walter	9	X	X
McKELLER	Hannah	47	X	X
	John	47		X
McKINNON	Adeliade Mildred	36	X	X
	Alexander	69	X	X
	Arthur Donald	36	X	X
	baby	69	X	
	June Bessie (CRAMER)	36	X	X
	Lionel Alexander	36	X	X
	Margaret (CADGER)	69	X	X
MOORE	Alonzo Ezra	66	X	X
	Ernest H.	66	X	X
	Ethel Annetta <u>WOLSTENHOLME</u>	49	X	X
	George Herbert	66	X	X
	Mary Jane (ULLYOT)	66	X	X
	Samuel W.	66	X	X
	Sarah (POWERS)	66	X	X
	Thomas	66	X	X

SURNAME	GIVEN NAMES	Plot #	CR	MI
MORTIMER	John	74	X	
MUIR	Elizabeth <u>LINKLATER</u>	52	X	X
MUNDELL	baby	41	X	
	Evaline	41	X	X
	William James	41	X	X
NEAR	Alice May	67	X	
	Harold William	67	X	
	Nettie Amelia	67	X	
NICHOL	baby	30	X	
NYCHUK	Anne Marie <u>CITULSKY</u>	71	X	X
OLLETT	Anne Fletcher	40	X	X
	Ivy Eleanor	41	X	
	James	40	X	X
	May	41	X	
	Robert	41	X	X
	William	40	X	X
	William A.	40	X	X
	William James	41	X	
OKLUND	June Linne <u>BOLLMAN</u>	42	X	X
PADDOCK	Bethia Cunningham (KELLY)	31	X	X
	Edith Merlyn	31	X	X
	Martin Ernest	31	X	X
	Martin John	31	X	X
	Kenneth George	31	X	
PETTAPIECE	Anne Wilhemina (HENDERSON)	39	X	X
	Daniel Hewitt Rodger	48		X
	Evelyn Agnes Minto <u>STRATFORD</u>	75	X	X
	Florence Ada (HARVEY)	39	X	X

SURNAME	GIVEN NAMES	Plot#	CR	MI
PETTAPIECE (cont.)	George Lawrence	34	X	X
	Gwendolyn Mabel	48	X	X
	Helen Clarinda (TAYLOR)	34	X	X
	Irene Spence (ROBERTSON)	48	X	X
	Janet Butter <u>GILES</u>	43	X	X
	Leslie Matthias	39	X	X
	Margaret Minto	48	X	X
	Matthias	48	X	X
	Ronald Keith	34	X	X
	Sadie Julia Elva (MacDONALD)	34	X	X
	Susan Muir	48	X	X
	Vera Hazel <u>WOLSTENHOLME</u>	44	X	X
	William Elgin	39	X	X
	William John	48	X	X
PHILIP	Frances Arlene <u>RADCLIFFE</u>	68		
POWERS	Sarah <u>MOORE</u>	66	X	X
PRIMMER	Helen C.	55	X	X
	Margaret Agnes <u>DAY</u>	55		X
	William Marshall	55	X	X
PROKAPOW	Phillipe	26	X	
PURDY	Leslie Anne	39	X	X
RADCLIFFE	Clara Alice	68	X	X
	Frances Arlene (PHILIP)	68		
	John	68	X	X
	John Webb	68	X	X
	Margaret Ann (WEBB)	68	X	X
	Lorne Murray	68	X	X
	“Bob” Robert	68	X	X

SURNAME	GIVEN NAMES	Plot #	CR	MI
REID	Edna Mildred <u>SPEARIN</u>	60	X	X
REYNAUD	Wayne R.	57	X	X
RITCHIE	May <u>STRATFORD</u>	75	X	X
ROBERTSON	Christina (FERGUSON)	46	X	X
	Elgin	48	X	X
	Irene Spence <u>PETTAPIECE</u>	48	X	X
	Magnus	46	X	
	Peter	46	X	X
	Mrs <u>MacDonald</u>	46	X	
ROBINSON	Annie H. (HENRY)	10	X	X
	Margaret M.	10	X	X
	William Durward	10		X
ROLSTON	Annie <u>McCLENAGHAN</u>	9	X	X
ROSE	Mary Muriel <u>WOLSTENHOLME</u>	65	X	X
SCLATER	Albert Ward	25	X	X
	Jessie Thomson	27	X	
	Lillian Inkster <u>KENNEL</u>	27	X	X
	Mary Marjorie (JOHNSTON)	25	X	X
	Ronald Johnston	25	X	X
	Ronald Ward	27	X	X
SHANKS	Ann	81	X	X
	Annie (GRAHAM)	80	X	X
	Charlie baby	79	X	
	Doreen Patricia (KITE)	1	X	X
	Ellen (LAWSON)	81	X	X
	Elizabeth <u>HAIGHT</u>	64	X	X

SURNAME	GIVEN NAMES	Plot #	CR	MI
SHANKS (cont.)	Graham Lawson	80	X	X
	Ida Florence (WRIGGLESWORTH)	78	X	X
	John	80	X	X
	John Edward (Ted) Graham	80		X
	John T.	78	X	X
	Kathleen Myrtle	73		X
	James	78	X	X
	James Gordon	73	X	X
	James W.	81	X	X
	Janette Burnett <u>KITE</u>	1	X	X
	Jane Pender <u>GRUMMETT</u>	62	X	X
	Laura Elfreda	80	X	X
	Margaret <u>KAHLER</u>	65	X	X
	Margaret A. (TINGLE)	78	X	X
	Margaret Cameron (GREIG)	79	X	X
	Martha Myrtle (STRATFORD)	73	X	X
	Mary Ellen <u>KELLY</u>	63	X	X
	Mildred Grace (SPEARIN)	80	X	X
	Norma Hazel (JOHNSON)	78	X	X
	Rachel Maude (WILCOTT)	79	X	X
	Robert Crosbie	78	X	X
	Robina Euing <u>GRAHAM</u>	81	X	X
	Thomas	78	X	X
	Thomas	79	X	X
	Thomas Lorne	79	X	X
	William	81	X	X
	William Graham (1867-1944)	79		X
	William Pender	80	X	X

SURNAME	GIVEN NAMES	Plot #	CR	MI
SHORT	Caroline E.	59	X	X
	Agnes Clara <u>HORNIBROOK</u>	54	X	X
	Ester Elizabeth (HYNDMAN)	59	X	X
	George H.	59	X	X
	Richard R.	59	X	X
	Lawrence Howell	59	X	X
SMITH	Henry J.	45	X	X
SNOWDEN	Eileen C.	76	X	X
	Ernest	76	X	X
	George Ronald	76	X	X
	James	76	X	X
	James J.	76	X	X
	Martha	76	X	X
	Mary Anne	76	X	X
	Robert	76	X	X
SNUGGS	Arthur	3		X
	Gladys Linder Edna	3	X	X
	Mary	3		X
SOLDAN	baby	43	X	
SPARLING	Ernest William	28	X	
SPEARIN	Cecil Jackson	47	X	X
	Edna Doreen (BRYNELSON)	47	X	X
	Edna Mildred (REID)	60	X	X
	Howard M.	60	X	X

SURNAME	GIVEN NAMES	Plot #	CR	MI
SPEARIN (con't)	James	60	X	X
	Kenneth Howard	60	X	X
	Lillian M. (GILES)	43	X	X
	Margery Anne (LUTES)	45		X
	Mary Grace (BRAGG)	60	X	X
	Mildred Grace <u>SHANKS</u>	80	X	X
	Reid Melville	43	X	X
	William James Douglas	45	X	X
	Willie	60	X	X
STOROZUK	baby	26	X	
STRATFORD	Evelyn Agnes Minto (PETTAPIECE)	75	X	X
	Gibson Ritchie	75		X
	James Lawrence (Larry)	75	X	X
	James Ritchie	75	X	X
	John Playfair	75	X	X
	Martha Myrtle <u>SHANKS</u>	73	X	X
	May (RITCHIE)	75	X	X
SWITZER	Mary Elfred (WOLSTENHOLME)	49	X	X
TAIT	Eleanor	4	X	X
TAYLOR	Helen Clarinda <u>PETTAPIECE</u>	34	X	X
THOMPSON	Euphemia <u>KAHLER</u>	77	X	X
TICONICE	Tony	2	X	
TIESSEN	Margareta	8	X	X
	Margareta	8	X	X
TINGLE	Margaret A. <u>SHANKS</u>	78	X	X
TOTH	Charlotte Mary <u>MacDONALD</u>	26	X	X
TWIGGE	Robert McLeod	33	X	X
	Zella Mildred	33	X	X
	Maybelle CHAPLEAU	33		
	Barry	33		X

SURNAME	GIVEN NAMES	Plot #	CR	MI
ULLYOT	Mary Jane <u>MOORE</u>	66	X	X
WATT	Muriel Eileen <u>WOLSTENHOLME</u>	65	X	X
	Margaretta (KERR)	72	X	X
	Margaretta	72		X
	William	72	X	X
WEBB	Margaret Ann <u>RADCLIFFE</u>	68	X	X
WHITE	Clara Edith M. <u>EDWARDS</u>	57	X	X
	Maria (BROWN)	57	X	X
	James	57		X
	Samuel J.J.	57	X	X
WILCOTT	Elizabeth	79	X	X
	Rachel Maude <u>SHANKS</u>	79	X	X
WOLSTENHOLME	Allan Elgin Garth	65	X	X
	Betty	49		X
	Brian Moore	44	X	X
	Ethel Annetta (MOORE)	49	X	X
	Gilbert Moore	65	X	X
	Harry Samuel	44	X	X
	Lola Margaret	49	X	X
	Leech	49	X	X
	Margery Edna	49	X	X
	Mary Elfred <u>SWITZER</u>	49	X	X
	Mary Muriel (ROSE)	65	X	X
	Muriel Eileen (WATT)	65	X	X
	Norman Alfred	49	X	X
	Thomas	49	X	X
	William Kaye	49	X	X
	Vera Hazel (<u>PETTAPIECE</u>)	44	X	X
WRIGGLESWORTH	Ida Florence <u>SHANKS</u>	78	X	X